

ESSENTIAL INDIVIDUAL COMPONENTS

IGNITION SWITCH

The ignition switch (1) is below the indicator panel.

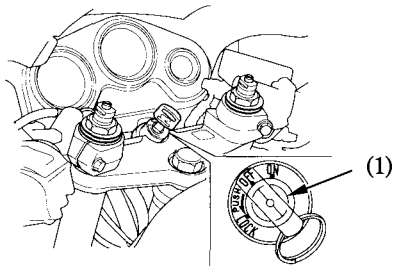

(1) Ignition switch

You should received a key number plate (2) with your key.

You will need this key number if you ever have to replace a lost key. Store this plate in a safe place. < Except U, MX, BR >

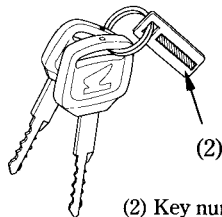

(2) Key number plate

Key Position	Function	Key Removal
LOCK (steering lock)	Steering is locked. Engine and lights cannot be operated.	Key can be removed
OFF	Engine and lights cannot be operated.	Key can be removed
ON	Engine and lights can be operated.	Key cannot be removed