

## Other Inspections & Lubrication

- Check that the clutch lever assembly is positioned properly (the end of the holder (1) aligned with the paint mark (2) on the handlebar) and the securing bolts are tight.

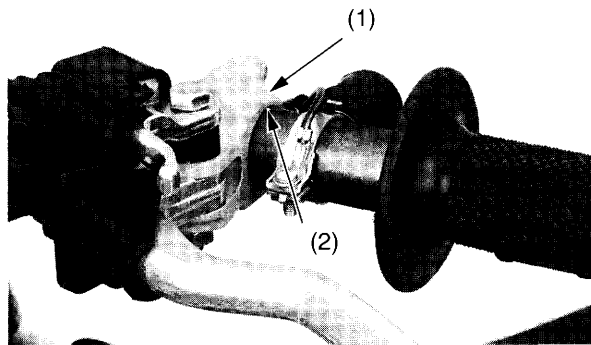

(1) holder (2) paint mark

- Check the clutch cable for kinks or signs of wear. If necessary, have it replaced.
- Lubricate the clutch cable with a commercially-available cable lubricant to prevent premature wear and corrosion.

## Clutch Operation

1. Check for smooth clutch lever operation. If necessary, lubricate the clutch lever pivot or clutch cable.
2. Check the clutch cable for deterioration, kinks, or damage.

## Clutch Cover/Disc/Plate Removal

1. Drain the transmission oil (page 47).
2. Remove the rear brake pedal (1) by removing the pin (2) and pivot bolt (3), washer (4) and dust seals (5).

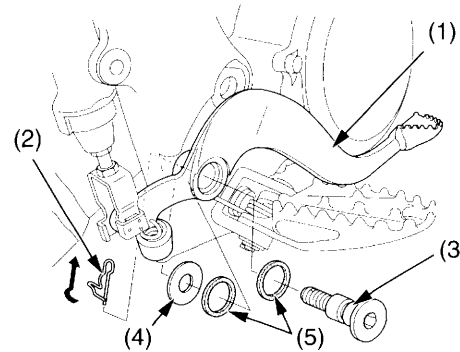

(1) rear brake pedal (2) pin  
(3) pivot bolt (4) washer  
(5) dust seals

3. Remove the five clutch cover bolts (6) and clutch cover (7).

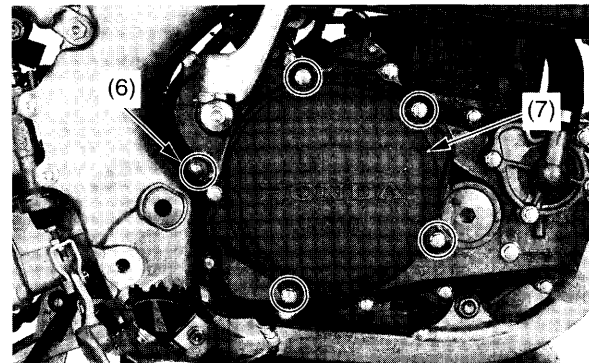

(6) clutch cover bolts (7) clutch cover

4. Remove the five clutch spring bolts and clutch springs (8).

Loosen the bolts in a crisscross pattern in two or three progressive steps.

5. Remove the clutch pressure plate (9).

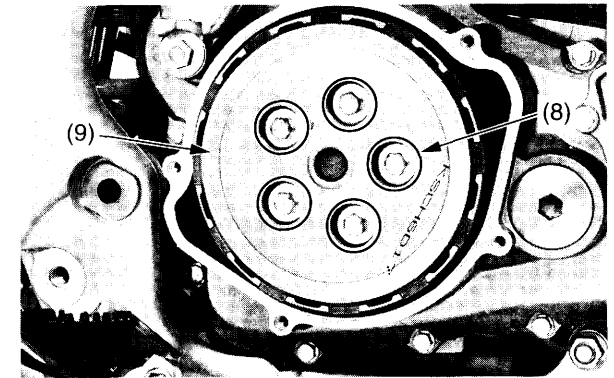

(8) clutch spring bolts/clutch springs  
(9) clutch pressure plate

6. Remove the clutch lifter assembly (10) and clutch lifter rod (11).
7. Remove the eight clutch discs, seven clutch plates, judder spring and spring seat (12). Turn the lifter bearing plate of the clutch lifter with your finger. The bearing plate should turn smoothly and quietly. Discard the clutch lifter if the bearing plate does not turn smoothly.

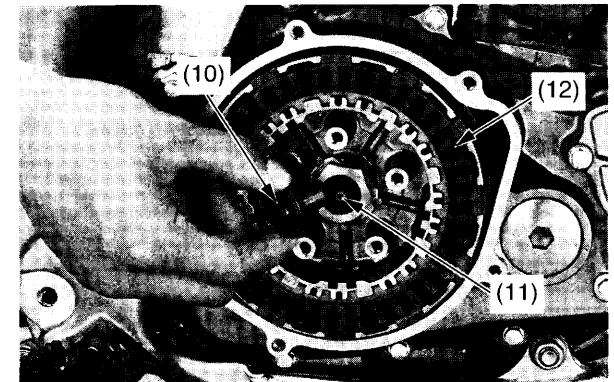

(10) clutch lifter assembly  
(11) clutch lifter rod  
(12) clutch discs, clutch plates, judder spring and spring seat