



Engine Oil & Filter

Install a New Engine Oil Filter:

Place shop towels under the oil filter cover because oil will flow out.

1. Remove the oil filter cover (1) by removing the bolts (2). Let the remaining oil drain out. Discard the oil filter (3) in an approved manner (page 182).
2. Check that the oil filter cover O-ring (4) is in good condition and then install a new oil filter. Use only the Honda Genuine oil filter or a filter of equivalent quality specified for your model. Using the wrong Honda filter or a non-Honda filter which is not of equivalent quality may cause engine damage.
3. Reposition the spring (5) to the new oil filter and install a new oil filter with the rubber seal (6) facing inward, inside the engine. You will see the spring on the oil filter body.

NOTICE

Improper installation of the oil filter can cause serious engine damage.

RIGHT SIDE

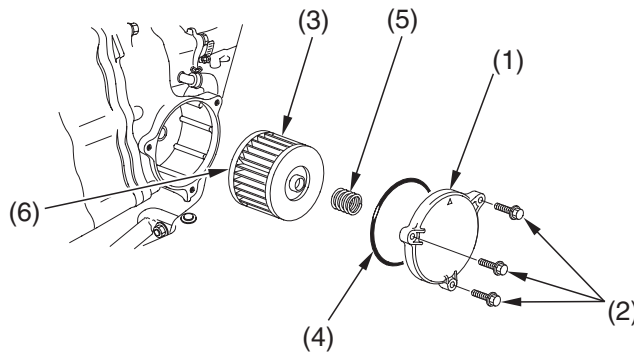

(1) oil filter cover

(2) bolts

(3) oil filter

(4) O-ring

(5) spring

(6) rubber seal