

# Operating Controls

---

## Front Brake Lever

The front brake lever ( 1 ) is used to slow or stop your ATV. To operate, pull the lever. For information on braking techniques, see page 63 .

## Rear Brake Lever

The rear brake lever ( 2 ) is used to slow or stop your ATV. To operate, pull the lever. For information on braking techniques, see page 63 .

## LEFT & RIGHT HANDLEBAR

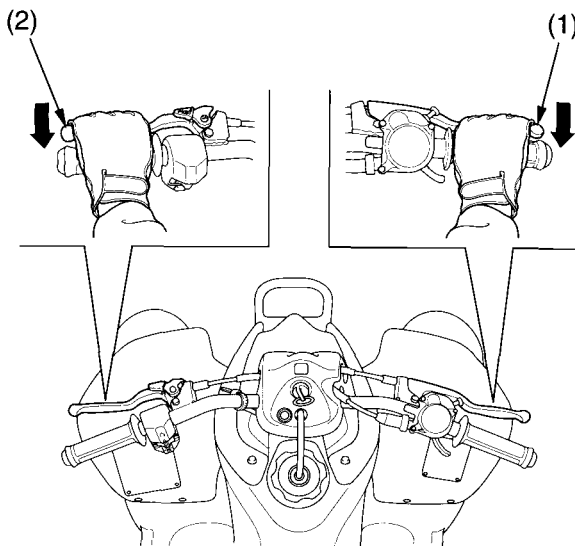

(1) front brake lever

(2) rear brake lever