

Battery Removal

1. Remove the seat (page 49).
2. Remove the ignition control module (1).
3. Remove the battery cover (2) by removing the screw (3).

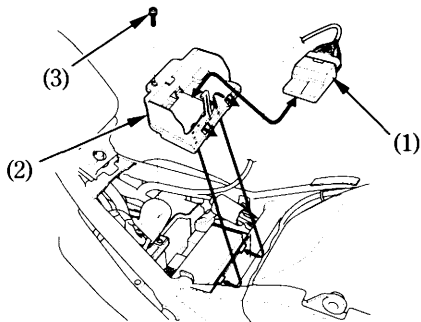

- (1) Ignition control module
(2) Battery cover
(3) Screw

4. Disconnect the negative (-) terminal lead (4) from the battery first, then disconnect the positive (+) terminal lead (5).
5. Pull out the battery (6) from the battery box.

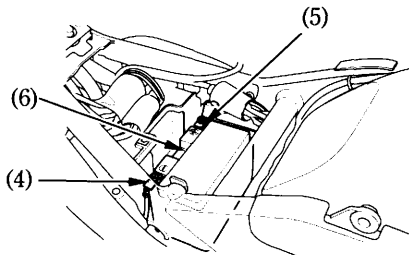

- (4) Negative (-) terminal lead
(5) Positive (+) terminal lead
(6) Battery