

# Clutch System

Refer to *Safety Precautions* on page 47 .

## Inspection

The engine should start easily with the kickstarter without the clutch slipping. When shifting gears, the clutch operation should be smooth and light, especially when shifting into neutral.

## Adjustment

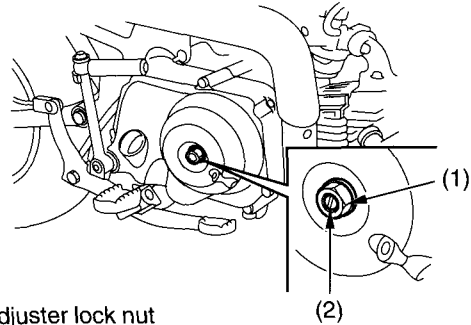

- (1) adjuster lock nut
- (2) clutch adjuster

1. Loosen the adjuster lock nut ( 1 ).
2. Turn the clutch adjuster ( 2 ) clockwise one turn; do not turn excessively.

(cont'd)