

Pour half the required amount of recommended fork fluid in the fork leg.

Specified fork fluid:

ED/3ED: Tech OJ 01
2ED/4ED: Showa SS05

Pump the fork tube slowly 8-10 times.
 Pour additional fluid to the specified capacity.

	ED/3ED	2ED/4ED
Oil level	100 mm (3.9 in)	87 mm (3.9 in)
Oil capacity (orientative)	410 cc (13.9 US oz) (14.4 Imp oz)	405 cc (13.7 US oz) (14.3 Imp oz)

NOTICE

Totally extended fork may cause oil leakage.

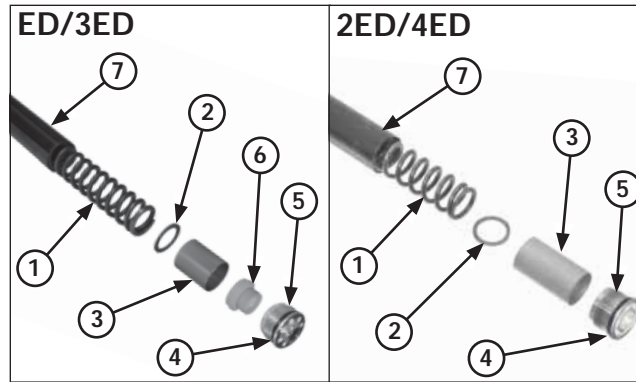

- (1) FORK SPRING
- (2) SPRING SEAT
- (3) DISTANCE COLLAR
- (4) O-RING
- (5) FORK BOLT
- (6) TAPERED BUSHING (ED/3ED)
- (7) FORK TUBE

Install the fork spring, spring seat, distance collar and the tapered bushing (ED/3ED).

Apply recommended fork fluid to the new O-ring, then screw the fork bolt into the fork tube.

Torque:
ED/3ED: 13.0 N•m (1.3 kgf•m)
2ED/4ED: 20.0 N•m (2.0 kgf•m)

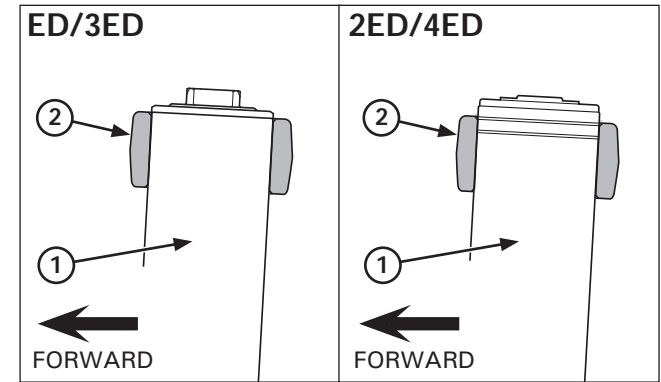

- (1) FORK TUBE
- (2) TOP BRIDGE

Installation

Install the fork leg.
 Raise the fork through the bottom bridge and top bridge.

Tech (ED/3ED)
 Place the fork tubes in the top clamp level as shown in the picture.

Showa (2ED/4ED)
 Place the fork tubes in the top clamp. The fork tubes should be in the first slot related top clamp.