

## Anti-theft Alarm System (Continued)

### Adjusting the Sensitivity of Anti-theft Alarm System

You can select from 3 sensitivity levels for the anti-theft alarm system.

- 1 Make sure that the Honda SMART Key system is active. **▶P.30**
  - 2 Remove the battery cover. **▶P.80**
  - 3 Push the ignition switch to authenticate the Honda SMART Key system. **▶P.34**
  - 4 Connect the EM mode coupler provided in the tool kit to the EM mode connector. **▶P.107**
- ▶ The Honda SMART Key indicator and ignition switch ring go off.

Alarm button

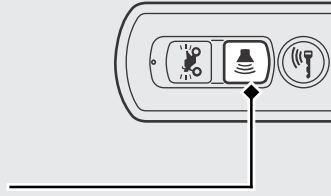

Ignition switch

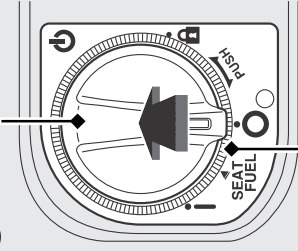

Ignition switch ring

- 5 Push the ignition switch 1 time.
- 6 Repeat the following 3 times:  
Press the alarm button on the Honda SMART Key 2 times and the ignition switch 1 time.
  - ▶ When the alarm button is pressed, the Honda SMART Key LED comes on. Make sure the LED goes off before pressing the button again.
  - ▶ If the alarm button or ignition switch is not pressed for 1 minute, the Honda SMART Key indicator starts blinking and this mode will be cancelled. If so, remove the EM mode coupler, return to **3** and follow the procedure again.