

Refuelling (Continued)

- 3 Turn the fuel fill cap counterclockwise and remove the fuel fill cap.

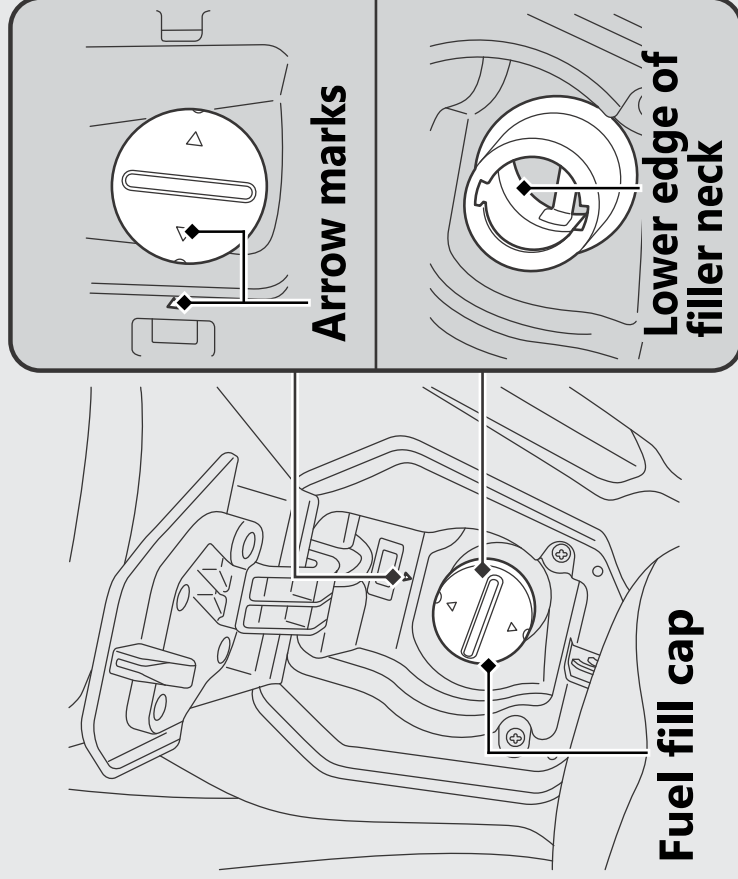

Do not fill with fuel above the lower edge of the filler neck.

Closing the Fuel Fill Cap

- 1 Install and tighten the fuel fill cap firmly by turning it clockwise.
 - ▲ Make sure that the arrow marks on the fuel fill cap and fuel tank are aligned.
- 2 Close the fuel lid until it locks.
 - ▲ Make sure that the fuel lid is closed securely.

⚠WARNING

Petrol is highly flammable and explosive. You can be burned or seriously injured when handling fuel.

- Stop the engine, and keep heat, sparks, and flame away.
- Handle fuel only outdoors.
- Wipe up spills immediately.