

Parking

FRONT

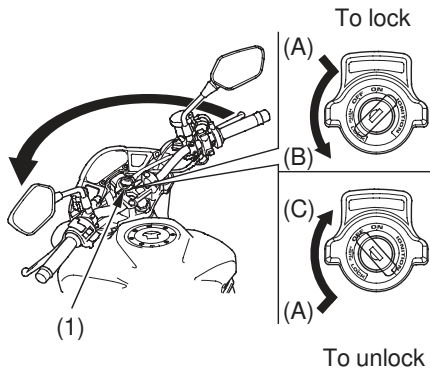

(1) ignition key

(A) push in
(B) turn to LOCK
(C) turn to OFF

3. Use the steering lock, which locks the handlebar in place. Turn the handlebar all the way to the left. Push in on the ignition key (1) and turn it to LOCK. Remove the key.

To unlock the steering lock, insert and push down on the key and turn it to the right to the OFF position.