

Front/Rear Turn Signal/Position Light Bulb

1. Remove the screw.
2. Remove the turn signal/position light lens and lens packing.
3. Slightly press the bulb and turn it counterclockwise.

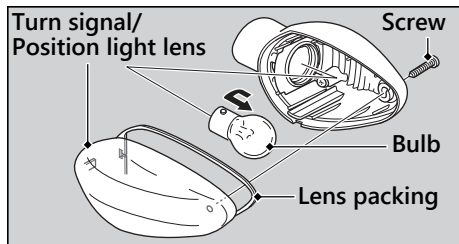

4. Install a new bulb and reinstall the parts in the reverse order of removal.

License Plate Light Bulb

1. Remove the screws, license light cover and license light cover packing.
2. Pull the bulb out of the socket without turning it.

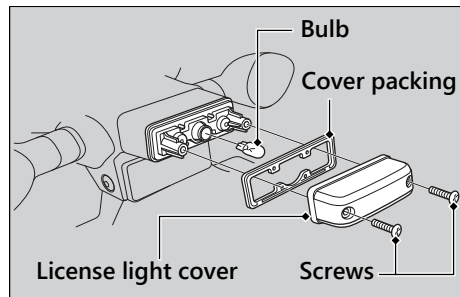

3. Install a new bulb and reinstall the parts in the reverse order of removal.