

## Audio System *(Continued)*

- 7 Select a target device name, and then press the **ENT** switch.

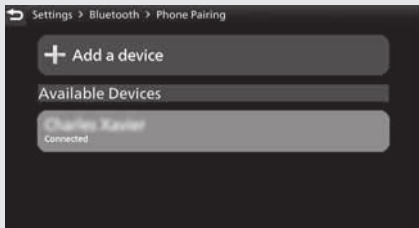

- 8 Select [Yes], and then press the **ENT** switch.



- 9 When a request message appears on the target device, tap "Pair."
- 10 When the pairing is complete, the name of the paired device are displayed.  
Icon status:

 : Phone function connected

 : Music function connected

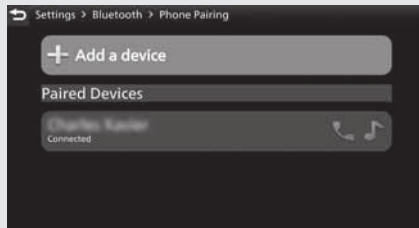

- 11 Return to the riding information, previous screen or Home screen. **P.38**