

# Right Side Cover Removal

Refer to *Safety Precautions* on page 43.

RIGHT SIDE

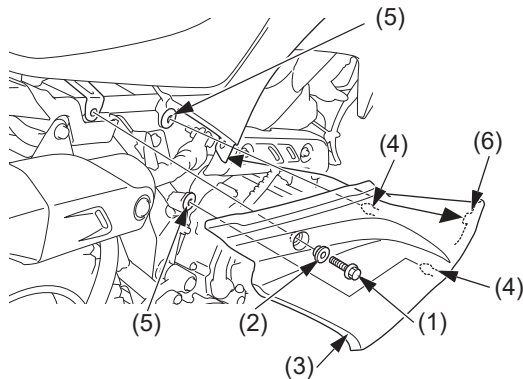

(1) bolt  
(2) collar  
(3) side cover

(4) prongs  
(5) grommets  
(6) tab

## Removal

1. Remove the bolt (1) and collar (2) securing the right side cover (3).
2. Pull the right side cover prongs (4) out of the rubber grommets (5).

## Installation

1. Attach the side cover on the rear frame, aligning its tab (6) with the rear lower edge of the right fuel tank shroud.
2. Align the side cover prongs with the rubber grommets. Press the side cover into position.
3. Install the bolt and collar, and tighten them.