

Exhaust Pipe/Muffler

(CRF450RWE)

1. Remove the right and left muffler (page 127).
2. Remove the right exhaust spring A (1).
3. Remove the right muffler mounting A bolt (2) and right muffler joint pipe (3).

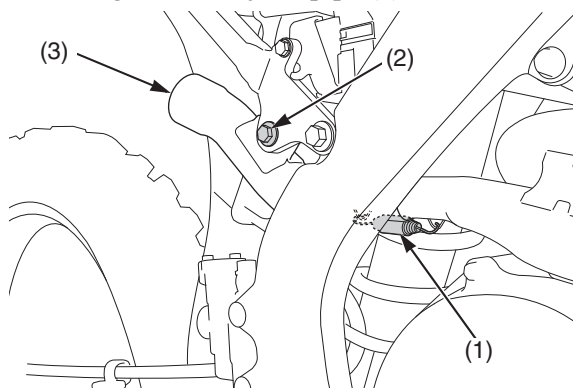

- (1) right exhaust spring A
(2) right muffler mounting A bolt
(3) right muffler joint pipe

4. Remove the upper drive chain roller (4) (page 123).
5. Remove the left exhaust spring A (5).
6. Remove the left muffler mounting A bolt (6) and left muffler joint pipe (7).

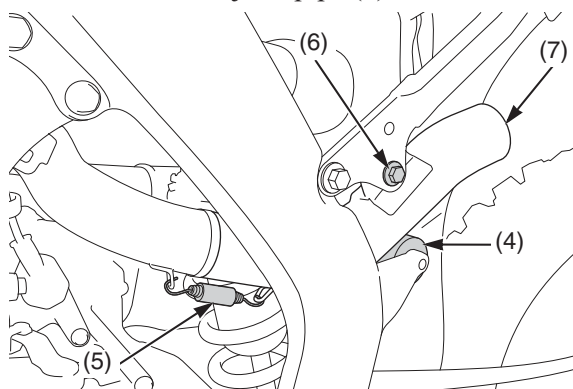

- (4) upper drive chain roller
(5) left exhaust spring A
(6) left muffler mounting A bolt
(7) left muffler joint pipe

7. Remove the exhaust springs B (8).
8. Remove the exhaust pipe joint nuts (9).
9. Remove the exhaust pipe (10), sleeve (11) and exhaust pipe flange (12) as a set.
10. Remove the gasket (13).

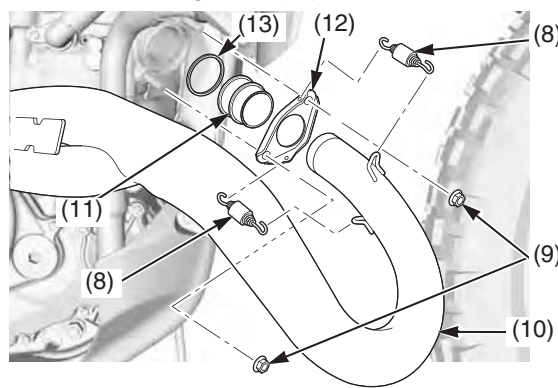

- (8) exhaust springs B
(9) exhaust pipe joint nuts
(10) exhaust pipe
(11) sleeve
(12) exhaust pipe flange
(13) gasket

Exhaust Pipe Installation

(CRF450R/RX)

1. Install a new exhaust pipe gasket (1).
2. Install the exhaust pipe (2) and exhaust pipe joint nuts (3) but do not tighten the nuts yet.

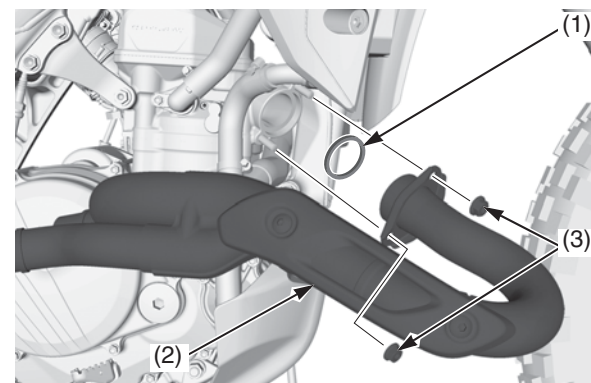

- (1) exhaust pipe gasket (new)
(2) exhaust pipe
(3) exhaust pipe joint nuts

3. Install the left and right mufflers (page 129) but do not tighten the bolts yet.
4. Tighten the exhaust pipe joint nuts to the specified torque:
15 lbf-ft (20 N·m, 2.0 kgf·m)
5. Tighten the left muffler clamp bolt, left muffler mounting A bolt and B bolt (page 127).
6. Tighten the right muffler clamp bolt, right muffler mounting A bolt and B bolt (page 127).