

## If a Fuse Blows

All of the electrical circuits on your CRF have a fuse to protect them from damage caused by excess current flow (short circuit or overload).

If something electrical on your CRF stops working, the first thing you should check for is a blown fuse. Check the fuse before looking elsewhere for another possible cause of the problem. Replace a blown fuse and check component operation.

- The main fuse (and spare) are located on the starter magnetic switch behind the right side cover.

### Recommended Main Fuse: 10A

1. To prevent an accidental short circuit, stop the engine.
2. Remove the seat (page 34).
3. Disconnect the negative (-) terminal (page 134).
4. Remove the right side cover and right air cleaner housing cover (page 126).

5. Remove the start magnetic switch stay bolt (1) and plastic wire band (2).
6. Pull out the start magnetic switch (3).
7. Remove the start magnetic switch cover (4).
8. Pull out the main fuse (5). If it is blown (6), install the spare main fuse (7).

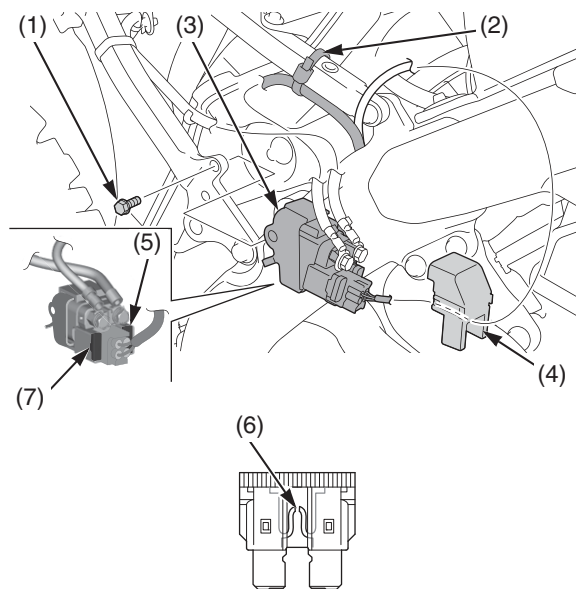

- (1) start magnetic switch stay bolt
- (2) wire band
- (3) start magnetic switch
- (4) start magnetic switch cover
- (5) main fuse
- (6) blown fuse
- (7) spare main fuse

9. Install the start magnetic switch cover (4).
10. Install the start magnetic switch (3).  
Install and tighten the start magnetic switch stay bolt (1) to the specified torque:  
**9 lbf·ft (12 N·m, 1.2 kgf·m)**
11. Install the plastic wire band (2).
12. Connect the negative (-) terminal (page 135).

If you do not have a replacement fuse with the proper rating for the circuit, install one with a lower rating.

### NOTICE

*Replacing a fuse with one that has a higher rating greatly increases the chance of damage to the electrical system.*

If you replace a blown fuse with a spare fuse that has a lower rating, replace the fuse with the correct rating as soon as you can. Also remember to replace the spare fuse that was installed.

If the replacement fuse of the same rating burns out in a short time, there is probably a serious electrical problem on your CRF.

Leave the blown fuse in that circuit and have your CRF checked by your dealer.

13. Install the right side cover, right air cleaner housing cover and bolts.
14. Install the seat (page 34).