

Frame servicing

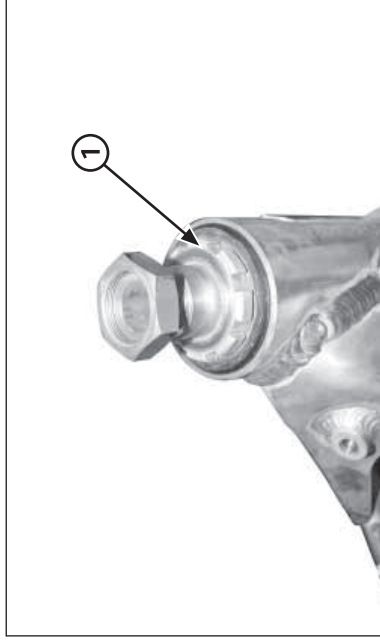

(1) ADJUSTING NUT

Screw the stem bearing adjusting nut all the way with your fingers.



Turn the steering stem lock-to-lock 5 times to seat the bearings and retighten the adjusting nut to the specified torque.

Torque: 5 N•m (0.5 kgf•m, 3.7 lbf•ft)

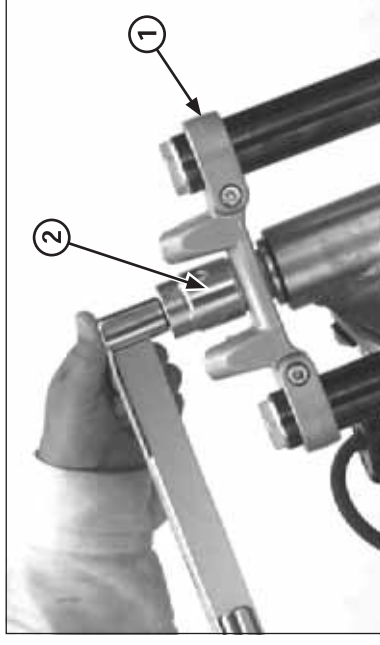

(1) TOP BRIDGE
(2) STEM NUT

Apply grease to the stem nut thread and seating surfaces. Install the top bridge, washer and stem nut.

Temporarily install both fork legs.

Apply grease to the top bridge pinch bolt threads and seating surfaces.

Install and tighten the top bridge pinch bolts to the specified torque.

Torque: 21 N•m (2.1 kgf•m, 15.4 lbf•ft)

Tighten the stem nut to the specified torque.

Torque: 99 N•m (10 kgf•m, 65 lbf•ft)

Recheck the steering stem adjustment before installing the removed parts.