

Steering lock

Locks the steering when parked to prevent possible theft of the motorcycle.

The use of a "U"-type anti-theft device for the wheel or other similar device is also recommended.

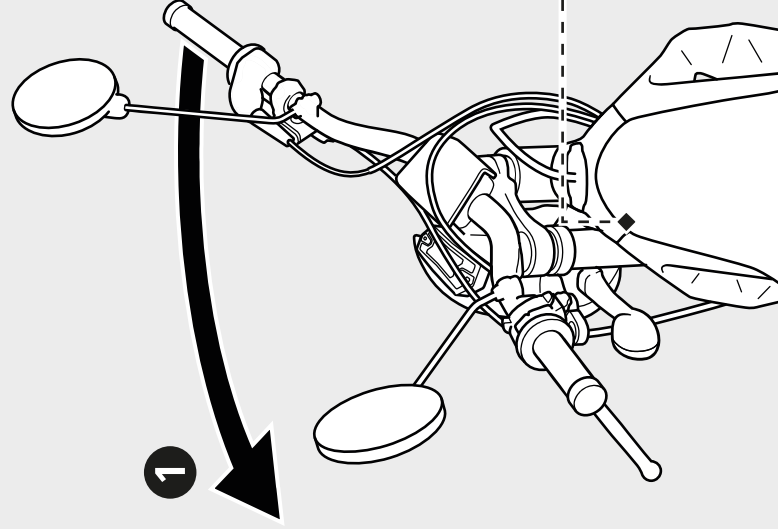

The steering lock is on the lower bridge of the front suspension.

Locking

- 1 Turn the handlebars all the way to the left.
- 2 Insert the key in the steering lock and turn it as far as it will go to the left.
Then press the lock all the way in and turn the key back to the original position.
 - ▲ Move the handlebars a little if it is difficult to lock.
- 3 Remove the key.

Unlocking

To unlock the steering, perform the locking sequence in the reverse order.