

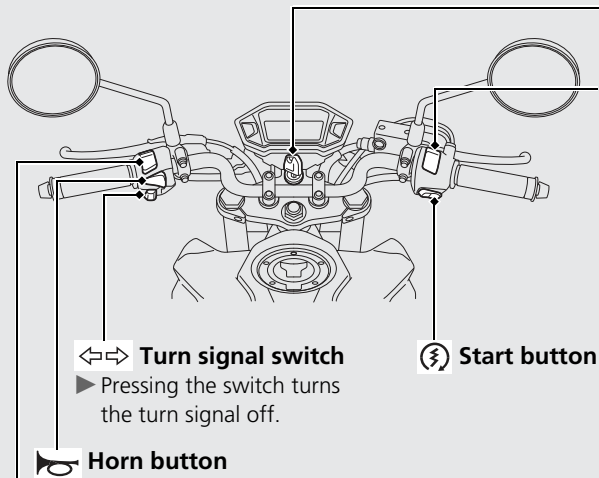

Switches





 **Turn signal switch**

▶ Pressing the switch turns the turn signal off.

 **Horn button**

Headlight dimmer switch

- : High beam
- : Low beam

Engine stop switch

Should normally remain in the  (Run) position.

▶ In an emergency, switch to the  (Off) position (the starter motor will not operate) to stop the engine.

 **Start button**