

# If a Fuse Blows

## Main Fuses Access

1. To prevent an accidental short circuit, turn the ignition switch to OFF (O) before checking or replacing the fuses.
2. Remove the seat ([page 130](#)).
3. Remove the rear fender cover ([page 131](#)).
4. To access the main fuse 1 (2), remove the fuse cover (3).
5. To access the main fuse 2 (4), remove the fuse box cover (5).

### UNDER REAR FENDER COVER

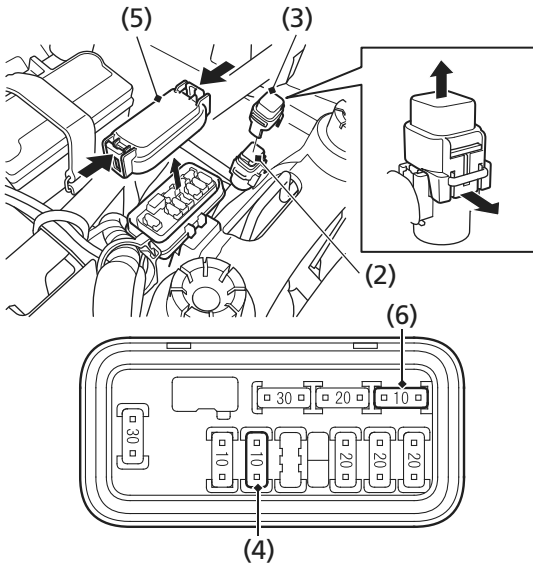

- (2) main fuse 1  
(3) fuse cover  
(4) main fuse 2

- (5) fuse box cover  
(6) spare fuse

6. Pull the main fuses out.

If the main fuse 1 is blown, install the spare fuse ([page 129](#)).

If the main fuse 2 is blown, install the spare fuse (6).

7. Install the fuse cover.

(cont'd)