

If You Have a Flat Tire

4. Remove the muffler bracket bolt A (2), B (3), nuts (4) and washers (5).
5. Remove the muffler.

RIGHT REAR

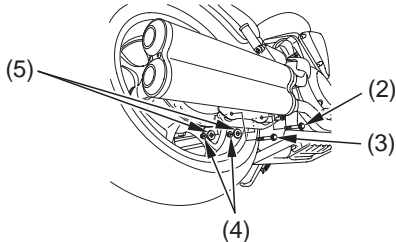

- (2) muffler bracket bolt A
- (3) muffler bracket bolt B
- (4) muffler bracket nuts
- (5) washers

6. Remove the axle holding bolt (6) and washer (7).
7. While holding the other end of the rear axle shaft (8) with a wrench, remove the rear axle nut (9) and washer (10).

LEFT REAR

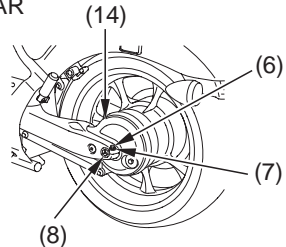

- (6) axle holding bolt
- (7) washer
- (8) rear axle shaft
- (14) final drive gear case

(cont'd)