

Rear Brake Pedal Freeplay

Refer to *Safety Precautions* on page 60 .

Pedal Height Adjustment

The stopper bolt is provided to allow adjustment of the pedal height.

1. Loosen the lock nut (1) and turn the stopper bolt (2).
2. Tighten the lock nut.

Inspection

1. Place your motorcycle on its side stand.
2. Check freeplay by slowly depressing the rear brake pedal (3) until the brake starts to engage.

Freeplay:

13/16 – 1 3/16 in (20 – 30 mm)

If necessary, adjust to the specified range.

RIGHT FRONT

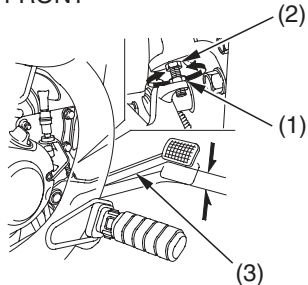

(1) lock nut

(3) rear brake pedal

(2) stopper bolt