

Inspecting the Rear Brake Pedal Freeplay

VT750C only

Pedal Height Adjustment

The stopper bolt is provided to allow adjustment of the pedal height.

1. Loosen the lock nut and turn the stopper bolt.
2. Tighten the lock nut.

Inspection

1. Place your motorcycle on a firm, level surface.
2. Measure the distance of the rear brake pedal before the starts to take hold.

Freeplay at the tip of the brake pedal: 13/16 to 1 3/16 in (20 to 30 mm)

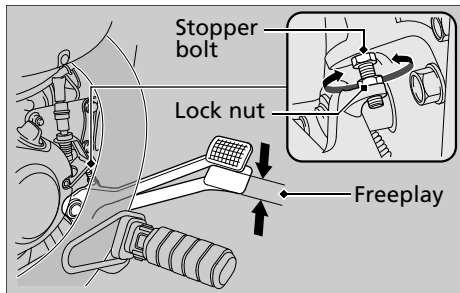

Make sure the brake rod, brake arm, spring and fastener are in good condition.