

B 2

**CYLINDRE - CULASSE
POT D'ECHAPPEMENT**

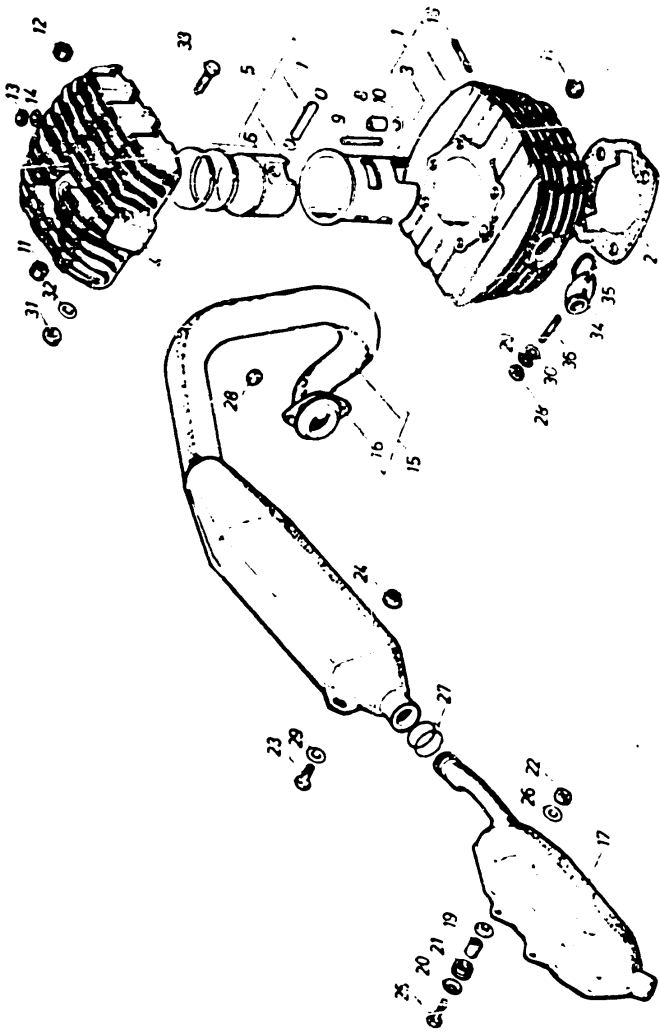

| N° de Réf. | REFERENCE PIECE | DESIGNATION | NBRE | N° DE SERIE |
|------------|-----------------|-----------------------------------|------|-------------|
| I | M5I60-02508 | CYLINDRE..... | 1 | |
| 2 | M5I60-02401 | JOINT DE CYLINDRE..... | 1 | |
| 3 | M5I60-02707 | CHEMISE..... | 1 | |
| 4 | M5I60-02805 MH | CULASSE..... | 1 | |
| 5 | M5I60-07403 | ENSEMBLE DE PISTON (S.T.D.)..... | 1 | |
| 5 | M5I600743 S020 | ENSEMBLE DE PISTON (0,20)..... | 1 | |
| 5 | M5I600743 S045 | ENSEMBLE DE PISTON (0 45)..... | 1 | |
| 6 | M5720-022 | SEGMENT (S.T.D.)..... | 2 | |
| 6 | M6660-022 | SEGMENT (0,20)..... | 2 | |
| 6 | M6660-0220 S25 | SEGMENT (0,45)..... | 2 | |
| 7 | M6660-021 | CIRCLIPS D'AXE DE PISTON..... | 2 | |
| 8 | M3360-161 | ECROU SPECIAL..... | 4 | |
| 9 | M5I60-031 | GOUJON (8 x 56 MM)..... | 6 | |
| 10 | M3360-162 | RONDELLE..... | 4 | |
| 11 | M02602210 L 145 | CAOUTCHOUC A..... | 36 | |
| 12 | M02602210 L 175 | CAOUTCHOUC B..... | 4 | |