

Fig. 6-21 ① Fuel tube ② Fuel valve

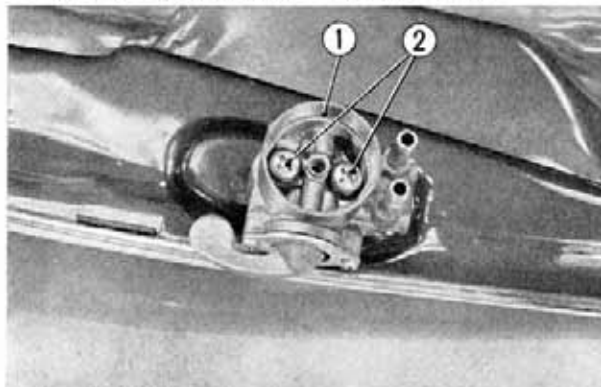

Fig. 6-22 ① Fuel valve
② Fuel valve mounting screws

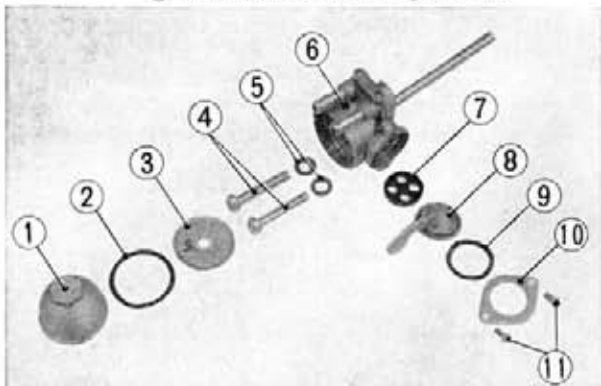

Fig. 6-23 ① Fuel strainer cup ② O ring ③ Fuel strainer screen ④ 6mm cross screws ⑤ Fuel cock fixing packing ⑥ Fuel valve body ⑦ Fuel cock valve packing ⑧ Fuel cock lever ⑨ Cock lever spring ⑩ Setting plate ⑪ Cross screws

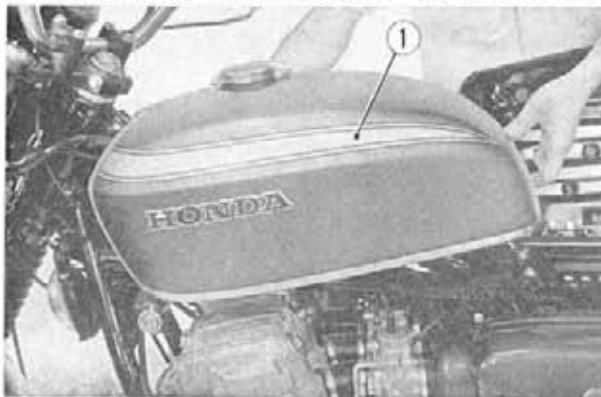

Fig. 6-24 Fuel tank

b. Disassembly

1. Switch the fuel valve to "STOP" and disconnect the fuel tube from the fuel valve. (Fig. 6-21)
2. Raise the seat, open the fuel tank rear cushion and remove the fuel tank to the rear and raise.
3. Remove the fuel strainer cap, O ring and fuel strainer screen.
4. Remove the two fuel valve mounting screws and remove the fuel valve from the tank. (Fig. 6-22)

c. Inspection

1. Inspect the fuel for leaks.
2. Inspect for clogging of the filler cap vent hole.
3. Inspect the front and rear cushion rubbers for deterioration, wear and other damages.
4. Inspect for damage to the valve cock packing and the filter screen, and then clean them with gasoline. (Fig 6-23)
5. Inspect the fuel tube for defects.

d. Reassembly

1. Install the fuel cock assembly on the tank with two screws.
2. Fit the front and rear rubber cushions to the frame body. The front rubber cushions should be inserted by pushing the fuel tank from the rear. (Fig. 6-24)

Install the fuel tank rear bracket on the rear cushion.

Note: When installing the tank, particular attention should be give to the condition of the wires and their routing.

3. Install the fuel lines using fuel tube clips and connect the fuel tubes to the tank valve.
4. Turn the fuel valve cock to the "ON" position and check the fuel for leaks.