

## REAR WHEEL

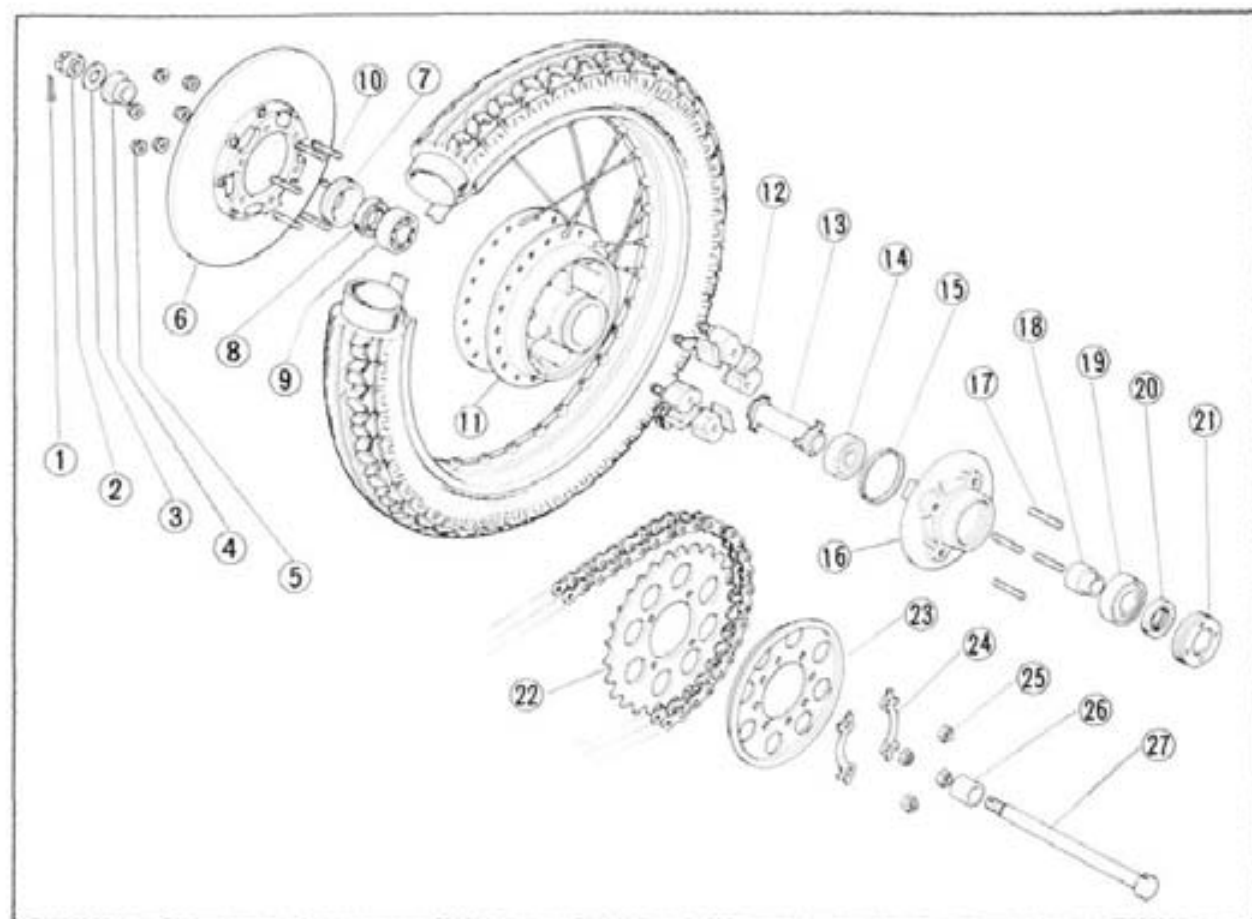

Fig. 49

- |                    |                     |                      |                       |
|--------------------|---------------------|----------------------|-----------------------|
| ① Cotter pin       | ⑧ Oil seal          | ⑮ O-ring             | ⊗ Drive sprocket      |
| ② Rear axle nut    | ⑩ 6304 bearing      | ⑯ Final drive flange | ⊗ Plate sprocket side |
| ③ 18.5×34 washer   | ⑪ Stud bolt         | ⑰ Stud bolt          | ⊗ Lock washer         |
| ④ Side collar      | ⑫ Rear wheel hub    | ⑱ Axle sleeve        | ⊗ Hex Nut             |
| ⑤ Disc nut         | ⑬ Rear wheel damper | ⑲ 6305 bearing       | ⊗ Side collar         |
| ⑥ Disc             | ⑭ Distance collar   | ⑳ Oil seal           | ⊗ Rear wheel axle     |
| ⑦ Bearing retainer | ⑳ 6304 bearing      | ㉑ Bearing retainer   |                       |

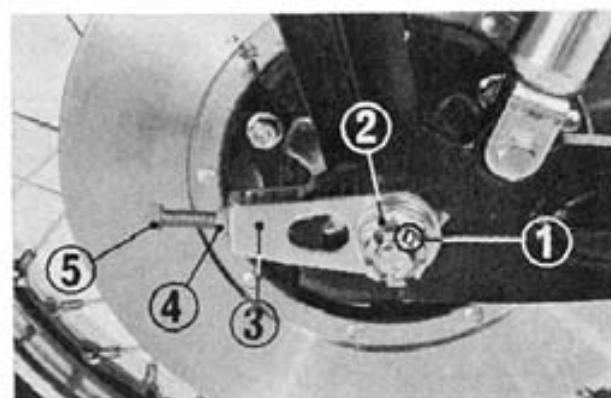

Fig. 50 ① Cotter pin ④ Lock nut  
 ② Axle nut ⑤ Chain adjusting bolt  
 ③ Drive chain adjuster

## Disassembly

1. Loosen the drive chain adjusting bolt and lock nut. Pry the cotter pin off the axle shaft and turn off the axle nut.