

HYDRAULIC BRAKE

INSTALLATION

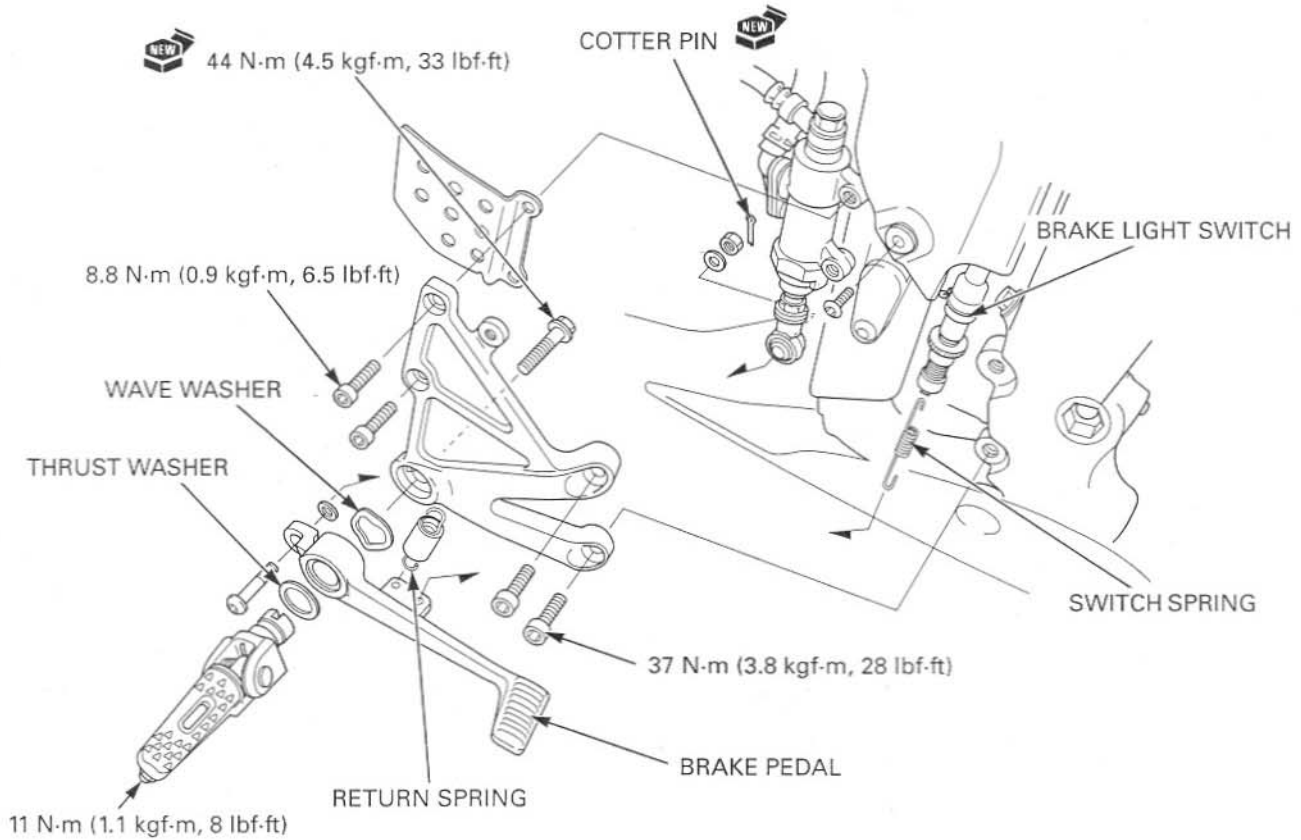

Apply grease to the sliding surface of the brake pedal and footpeg.
Install the wave washer, brake pedal, thrust washer, footpeg bracket and footpeg bolt.

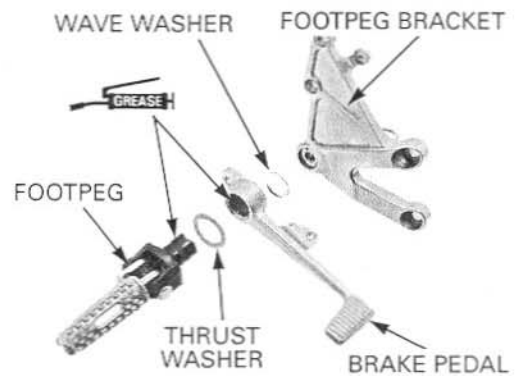

Install a new footpeg bolt and tighten it to the specified torque.

TORQUE: 44 N·m (4.5 kgf·m, 33 lbf·ft)

Hook the brake pedal return spring.

Install the brake light switch and hook the switch spring.

Connect the brake pedal to the push rod lower joint. Install the bolt, washers, nut and tighten the nut securely.

Install a new cotter pin.

